

# W-03CDB3

1/3" Multi-function Color Board Camera with CS Lens Mount

High functionality and high sensitivity for demanding scene conditions

Available in September, 2015

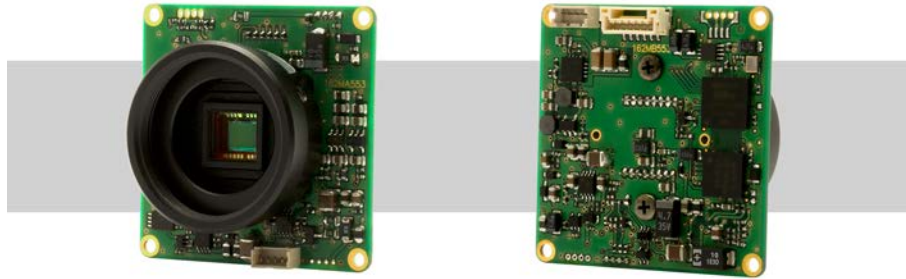

## Key features

- 1/3-inch CCD sensor with high sensitivity 0.005 lx F1.2 and a resolution of 650TVL
- Advanced setting available by OSD (On-Screen Display) through an optional controller
- 2DNR, privacy masking, BLC (Back Light Compensation)
- Mirror image, white blemish correction, contour correction
- Manual iris lens, video drive iris lens and DC drive Iris lens compatible

## Dimensions

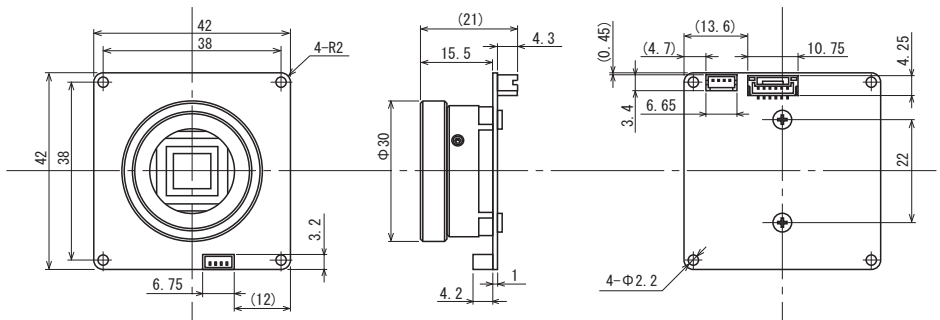

## Specifications

		NTSC	PAL
Video standard		NTSC	PAL
Pick-up element		1/3 inch interline transfer CCD image sensor	
Number of total pixels		1020(H) × 508(V)	1020(H) × 596(V)
Number of effective pixels		976(H) × 494(V)	976(H) × 582(V)
Unit cell size		5.40 μm(H) × 7.40 μm(V)	5.00 μm(H) × 6.25 μm(V)
Imaging system		Ye, Cy, Mg, and G complementary color mosaic filters on chip	
Synchronizing system		Internal	
Scanning system		2:1 interlace	
Video output		Composite video, 1.0 V(p-p), 75 Ω (Unbalanced)	
Resolution (H)		More than 650TVL (Center)	
Minimum illumination		0.005 lx F1.2	
S/N		More than 52dB	
Function settings		OSD(On Screen Display) operated by optional remote controller	
AE mode	Fixed	1/60, 1/100 sec.	1/50, 1/120 sec.
	EI	1/250, 1/500, 1/1000, 1/2000, 1/4000, 1/10000 sec.	
White balance		ATW, PUSH, USER1, USER2, ANTI CR, MANUAL, PUSH LOCK	
AGC	ON	-3 - 45dB	
	OFF	-3dB	
MGC		8 steps (Selectable)	
Gamma characteristics		$\gamma \approx 0.45$	
Noise reduction		2DNR ON / OFF	
Lens iris		Video / DC	
Back light compensation		OFF / BLC / HLC	
White blemish correction		Max 64 dots	
Defog		OFF / LO / MID / HIGH	
Privacy mask		8 masks	
Mirror image		ON (H-FLIP) / OFF	
Video level		0 - 255 (BRIGHTNESS)	
Setup level		7.5 IRE	0 IRE
Output switching		AUTO / COLOR / BW	
Sharpness		0 - 255 (SHARPNESS)	
Power supply		DC+12V ± 10%	
Power consumption		0.78W/65mA	
Operating temperature		-10 - +50°C	
Storage temperature		-30 - +70°C	
Operating / Storage humidity		95% RH or less (Without condensation)	
Lens mount		CS mount	
Weight		Approx. 29g	
Accessories		4P cable, Hex. wrench	

Accessories Options

**CS-mount lenses**

13VG308ASIR II 13VG1040ASIR

**Miniature lenses / Mount adaptors**

2520BC-12 0820BC-12  
2920BC-12 1220BC-12  
3820BC-12 0814BC-12  
0625BC-12 2540EX014-M12  
22PMA-M12-125

**C-mount adaptor**

C-mount Lenses  
30CMA-R  
※Not in our lineup

**W-03CDB3**

**IRIS(DC)**

Cable  
IRIS-Cable

**Conversion cable**

CC-02

**Remote control**

RC-01

**Cable**

4P-Cable

**Cable with connector**

CB-02

**Cables**

1.5C2V (BNC/BNC)  
3C2V (BNC/BNC)  
3C2V (BNC/RCA)

**Power supply adapters**

GF12-US1210  
G051T-120050B-1

OSD

VIDEO OUT

POWER IN (DC12V)

POWER IN (DC12V)

VIDEO OUT (BNC)

VIDEO OUT (BNC)

VIDEO OUT (RCA)



※Not in our lineup