

AMG250 SERIES INDUSTRIAL 10G MEDIA CONVERTERS WITH 30/60/90W POE



Industrial Ethernet Solutions

AMG's 10G industrial PoE media converters provide a multirate 1Gb or 10Gb Ethernet uplink across fiber via the SFP+ port with support for 30W or 60/90W PoE for maximum design flexibility.



| | | | | | | | |
|---------------|---------------|---------------------|--------------------|-------------------------|----------------------|----------------|-----------------------|
| | | | | | | | |
| 1/10 Gb x1 | 1/10 Gb x1 | Temp -40°C~+75°C | Protection IP40 | Mounting DIN/Surface | Mounting Magnetic | PSU x2 Dual | NDAA/TAA Compliant |

[AMG250-1XBT-1XS-P90]

OVERVIEW

Designed in a compact DIN rail or wall mount housing, the AMG250 series media converters are ideally suited for connecting high speed 10Gb equipment to Ethernet networks over long distances using all types of fiber through the integrated SFP+ port. Fiber connectivity is determined by separate SFP device selection, providing application and site flexibility.

Supporting PoE for IEEE802.3at 30W or IEEE802.3bt 60/90W they are suitable for powering the latest high powered PoE devices over a wide industrial operating temperature range.

AMG offers a wide range of industrial media converter models are available to suit all design requirements within the AMG250 and AMG260(M) model ranges.

SFPs and PSUs need to be ordered separately.

FEATURES

- Compact size – ideal for confined spaces, including camera poles and roadside cabinets
- -40°C to +75°C temperature maintains performance in extreme conditions
- Plug & Play – no need for any user configuration
- DIN rail mountable – quick to install and remove for maintenance
- SFP+ port is multirate 1Gb/10Gb – support single and multimode, single or dual fibre options up to 120Km
- Supports 15W, 30W, 60W and 90W PoE
- Auto-Negotiation (802.3u) – automatically determines the best connection speed
- Designed in the USA & UK. Manufactured in the United Kingdom
- AMG Lifetime Support Warranty

Specifications.

Standards.

| | |
|--------------|--------------|
| IEEE802.3ab | 1000Base-T |
| IEEE802.3z | 1000Base-X |
| IEEE 802.3an | 10GBase-T |
| IEEE 802.3ae | 10GBase-R |
| IEEE802.3af | 15W PoE |
| IEEE802.3at | 30W PoE+ |
| IEEE802.3bt | 60 & 90W PoE |

| | |
|-------------------|----------------------------------|
| Jumbo Frames | Transparent to Jumbo Frames |
| VLAN Support | Transparent to VLAN traffic |
| Multicast Support | Transparent to Multicast traffic |

| | |
|------------------|---|
| Operation Modes: | 1000Base-T to 1000Base-X 10GBase-T to 10GBase-R (It Is Not Possible To Mix Speeds Between RJ45 & SFP) |
|------------------|---|

Interface.

| | |
|-------------------|---|
| LED Indicators | 2x Power RJ45 Link/Activity SFP Link/Activity PoE 1G Operation Mode 10G Operation Mode |
| RJ45 Ports | 1x 1000/10G Base-T RJ45 with Auto MDI/MDI-X and 2 kV Isolation Protection |
| SFP Slot Power | 1x 1000/10G Base-R SFP+ 1x 4-way Screw Terminal |

Power.

| | |
|--------------------|--------------------------------------|
| Power Inputs | 2 |
| Operating Voltage: | |
| 30W PoE Mode | 48-56V _{DC} |
| 60/90W PoE Mode | 52-56V _{DC} |
| Power Consumption | 9W Max (without PoE Load) |
| PSE Modes | Mode A, Mode B |
| Protection | Reverse Polarity Overload Current |

Packaging.

| | |
|-----------------|---|
| Shipping Weight | 0.60kg / 1.32lb |
| Dimensions | (W x D x H) 220 x 170 x 40 mm 8.66 x 6.69 x 1.57 in |

Mechanical.

| | |
|-----------------------------|--|
| Housing | Anodised Aluminium |
| Dimensions: | (W x D x H) 37 x 88 x 107 mm 1.46 x 3.46 x 4.21 in |
| Excluding DIN & Wall Mounts | |
| IP Rating | IP40 |
| Installation | Wall Mount or DIN-Rail |
| Weight | 0.45kg / 0.99lb |

Environmental.

| | |
|------------------|--|
| Operating Temp: | |
| ≤70W PoE Load | -40 to +75°C / -40 to +167°F |
| ≤90W PoE Load | -40 to +60°C / -40 to +140°F |
| Storage Temp. | -40 to +85°C / -40 to +185°F |
| Humidity | 5% to 95% (non-condensing) |
| MTBF | >511,786 hours |
| MTBF Standard | Telcordia SR-332 GB 50°C |
| Heat Dissipation | 133 BTU/h (30W PoE) 338 BTU/h (90W PoE) |
| Cooling | Passive Cooling |
| Noise Level | 0 dBA |

Regulatory.

| | |
|---------------|--|
| Safety | EN 62368-1 |
| EMI | EN 55032 Class A CISPR 32 FCC Part 15B Class A |
| EMS | EN 61000-4-2 (ESD) EN 61000-4-4 (EFT) EN 61000-4-5 (Surge) |
| Shock | IEC 60068-2-27 |
| Free Fall | IEC 60068-2-32 |
| Vibration | IEC 60068-2-6 |
| Environmental | Reach RoHS WEEE |
| Supply Chain | NDAA & TAA Compliant |

Designed to meet NEMA TS2 & EN 50121-4

Part Numbers.

Single Channel 10G PoE Media Converters (1+1)

| | |
|---------------------|---|
| AMG250-1XBT-1XS-P90 | 1 × 1000/10GBaseT RJ45 with 30/60/90W PoE, 1 × 1000/10GBaseR Fx SFP |
|---------------------|---|

Included Accessories.

| | |
|------------------------|--|
| DIN Rail Adapter | Rear Mounted Metal DIN Rail Clip & Screws For DIN Rail Mounting AMG250 Series Products |
| Wall Mounting Brackets | 2x Wall Mounting Brackets & Screws For Wall / Surface Mounting AMG250 Series Products |

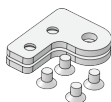
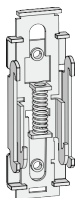

Recommended PSUs.

| | |
|------------------|--|
| AMGPSU-I48-P60A | DIN-Rail Mounting Industrial Grade PSU, -25 to +70°C, 43-55VDC, 60W* |
| AMGPSU-I48-P120A | DIN-Rail Mounting Industrial Grade PSU, -40 to +70°C, 48-55VDC, 120W** |

* Also available in kit form including mains line cord, DC cable and DIN rail. Order with -K at the end of the part code (e.g. AMGPSU-I48-P120A-K).
^ Also available with no exposed mains terminals and direct IEC input kit. Order with -IEC at the end of the part code (e.g. AMGPSU-I48-P120A-IEC).

Optional Accessories.

| | |
|--------------------------|---|
| AMGMNT-MAG-04 AMG2035 | 4x Rear Mounted Magnets & Screws Kit For AMG250 Series, need to be ordered separately Side Mounted Wall Bracket Adapter Kit For DIN Rail Mounting AMG250 Series Products In Depth Restricted Installations. Adapter Kit Can Be Extended Using The Included Extension Kit To Also Mount Additional Products or Power Supplies. |
|--------------------------|---|